

REV.	DATE	DESCRIPTION
A	01/25/04	UPDATE DRAWING FORMAT
B	01/17/07	REVISE BODY MATERIAL TO STAINLESS STEEL

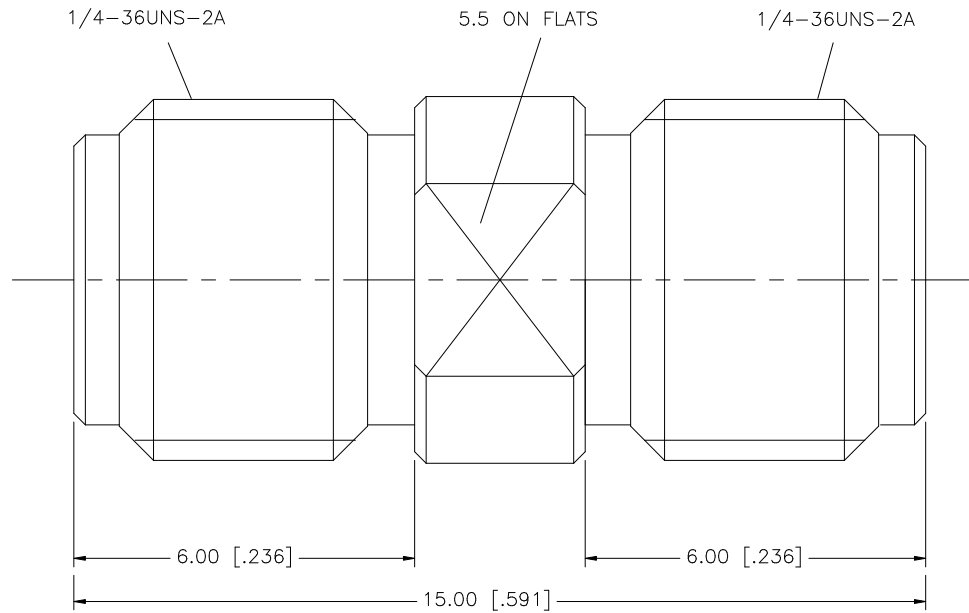

8					<small>UNLESS OTHERWISE SPECIFIED DIMENSIONS ARE IN MILLIMETERS. DIMENSIONS IN [] ARE IN INCHES AND FOR CUSTOMER REFERENCE ONLY.</small> <small>UNLESS OTHERWISE SPECIFIED TOLERANCES FOR MILLIMETERS ARE:</small> 0.5 - 8mm ± 0.20mm 8 - 30mm ± 0.40mm 30 - 120mm ± 0.50mm <small>UNLESS OTHERWISE SPECIFIED TOLERANCES FOR INCHES ARE:</small> .020 - .315 = ± 0.007" .315 - 1.180 = ± 0.015" 1.180 - 4.724 = ± 0.020"	APPROVALS	DATE	<h1 style="color: blue;">Amphenol Connex</h1>			
7				DRAWN		G.R.S.	01/17/07		PART DESCRIPTION <h2 style="text-align: center;">SNA FEMALE TO FEMALE ADAPTER</h2>		
6				CHECKED						PART NO. <h2 style="text-align: center;">132169SS</h2>	
5				ISSUED							
4					SHEET	1 OF 1					
3	CONTACT PIN	BER. COPPER	GOLD	1	CAD FILE	C:/132/132169SS.DWG	DWG. NO.	132169SS.DWG	REV. B	SIZE A	SCALE NA
2	INSULATOR	TEFLON	NATURAL	1							
1	BODY	STAINLESS STEEL	PASSIVATED S.S.	1							
	DESCRIPTION	MATERIAL	FINISH	QTY	DO NOT SCALE DRAWING						